



# STRONGARM

## The SafeWork Sensor

### How It Works



Volume  
Up & Down

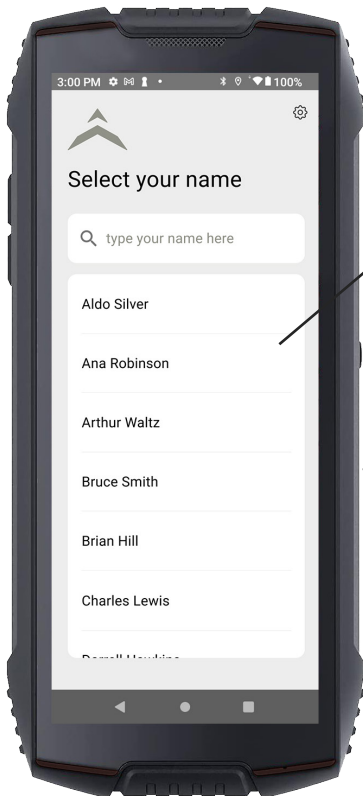

Charging Pin

**Device ID**  
Strongarm decal  
with barcode

**Touch Screen**  
Easily check out  
the device, review  
daily safety  
information,  
watch training  
videos, and find  
important tips.



### Primary Functions

- 1. Checkout Devices**  
Each team member selects their Name/Employee ID from a preloaded list displayed on the device touch screen.
- 2. Uploading Data**  
Network connection is required to upload sensor data. Easily connect via WiFi or a Strongarm provided hotspot.
- 3. Device Charging**  
The supplied charging dock should be plugged into the power source at all times. Plug in the device with the supplied charging cable. A green LED light signals active charging status.

# HARDWARE FEATURES

1

Select your language.

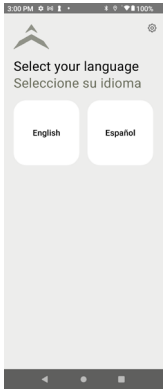

2

Select your name or employee ID. Press confirm to verify your selection.

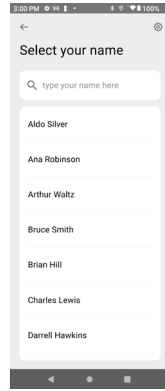

3

(optional)

Review the daily Safety Score metrics screen and the Haptic Alert information screen.

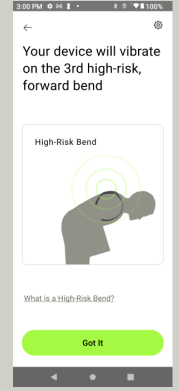
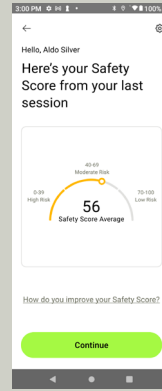

4

The device is ready to use and can be placed in the harness as instructed by program administrator. The display then shows an active session along with other information.

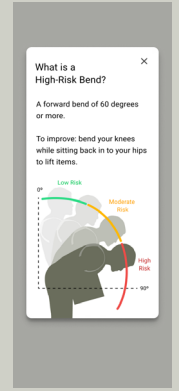
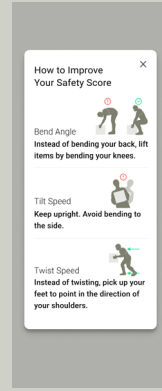
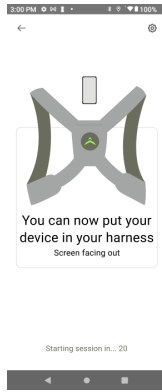
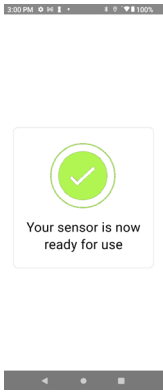

Additional information about how to improve your Safety Score and what is considered a High-Risk Bend Angle.

## DEVICE CHECK-IN

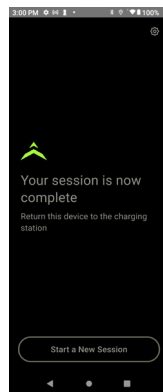

When you are ready to check the device back in, swipe the "Swipe to End Session" button on the screen to complete your session.

Connect the device to the charging cable so it's ready for the next user.

